

Lansdowne Road, W11

£925,000

Situated on the raised ground floor, this recently refurbished one-bedroom apartment has been meticulously designed to provide bespoke, modern interiors throughout. Offering large sash windows, sleek grey floors and a stunning en-suite bathroom, this flat is perfectly equipped for modern living.

Located in the heart of Notting Hill, this home is perfectly situated close to the many boutiques, bars and eateries found on Holland Park and Portobello Road. Holland Park and Ladbrooke Grove Underground stations are also close by.

- Modern open-plan reception room
- Bespoke kitchen
- Master bedroom with en-suite
- Large storage area
- Royal Borough of Kensington & Chelsea
- Approx. 686 sq ft / 63.7 sq m. EPC=D





Map

 Lansdowne Road, W11

Local Information

Architecture

- 1 Studio Stödberg
- 2 Kohn Pedersen Fox Associates
- 3 Form Studio

Art & Culture

- 1 Electric Cinema
- 2 Flow Gallery
- 3 Siegfried Contemporary

Design

- 1 Jonathan Adler
- 2 Graham & Green
- 3 Vessel

Fashion

- 1 Paul Smith
- 2 JOSEPH
- 3 Alice Temperley

Food & Drink

- 1 Aubaine
- 2 The Grocer On Elgin
- 3 Gail's

Indulge

- 1 Boutique Spa
- 2 Cowshed Spa
- 3 Bodyism

Shopping

- 1 Provenance
- 2 Harper and Tom's
- 3 The Marshmallowists

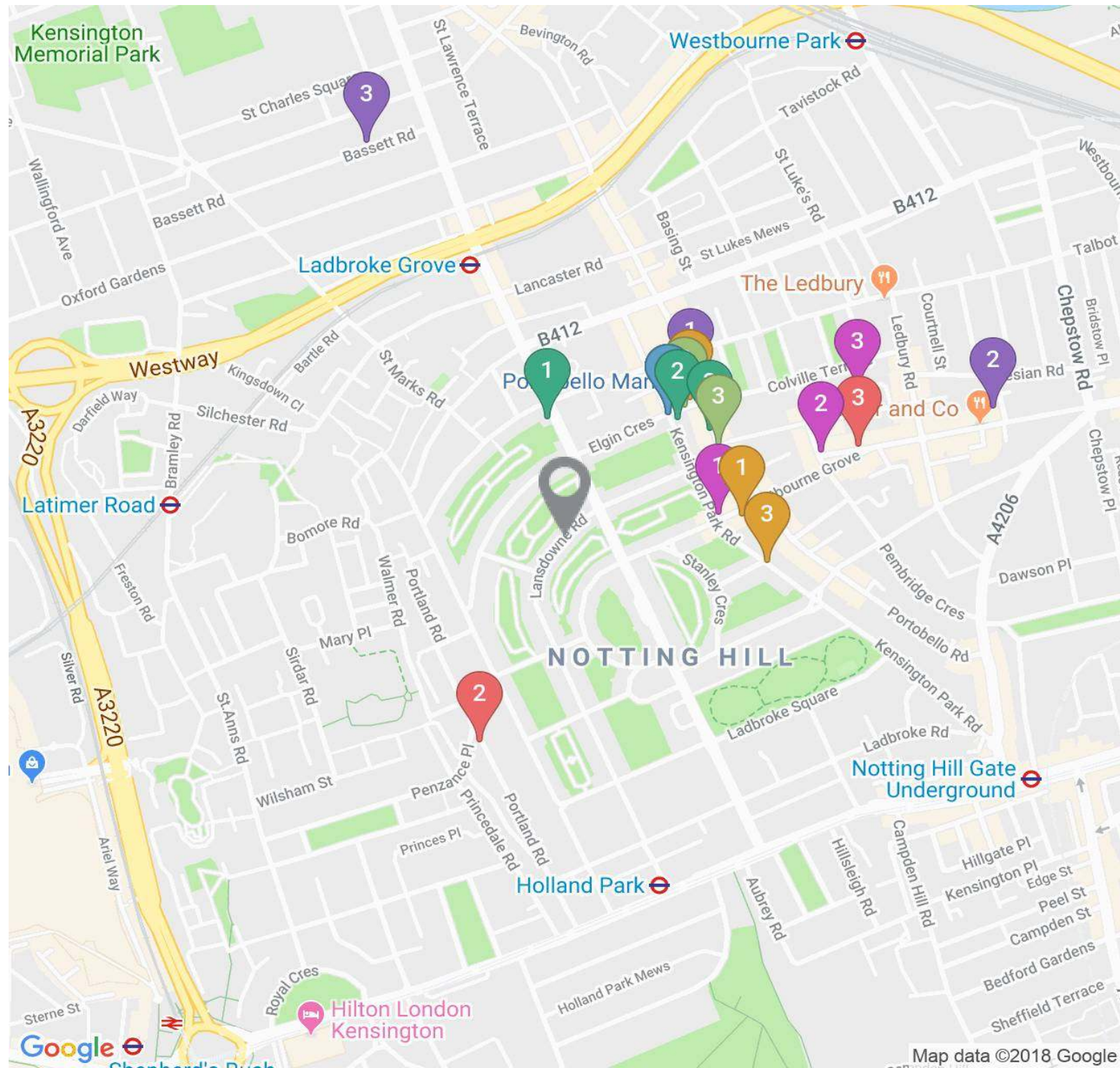

Floor plan

This image is illustrative only

(Not to scale)

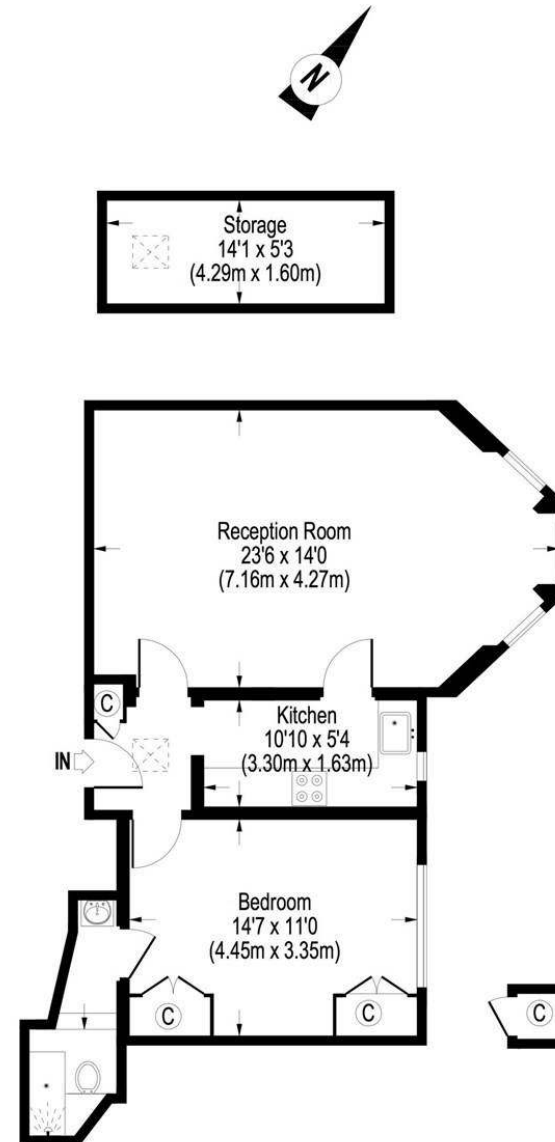

Raised Ground Floor

Approximate Gross Internal Area
(Excluding Storage) = 612 Sq.Ft. / 56.9 Sq.M.
(Including Storage) = 686 Sq.Ft. / 63.7 Sq.M.

Floor Plans are illustrative purposes only and not to scale.
Compliant with RICS code of measuring practice.

Contact

1 Domus Nova Notting Hill

17 Kensington Park Road, London W11 2EU

020 7727 1717

nottinghill@domusnova.com

2 Domus Nova Bayswater

78 Westbourne Grove, London W2 5RT

020 7221 7817

bayswater@domusnova.com

3 Domus Nova Property Management

37 Alexander Street, London W2 5NU

020 7908 9338

management@domusnova.com

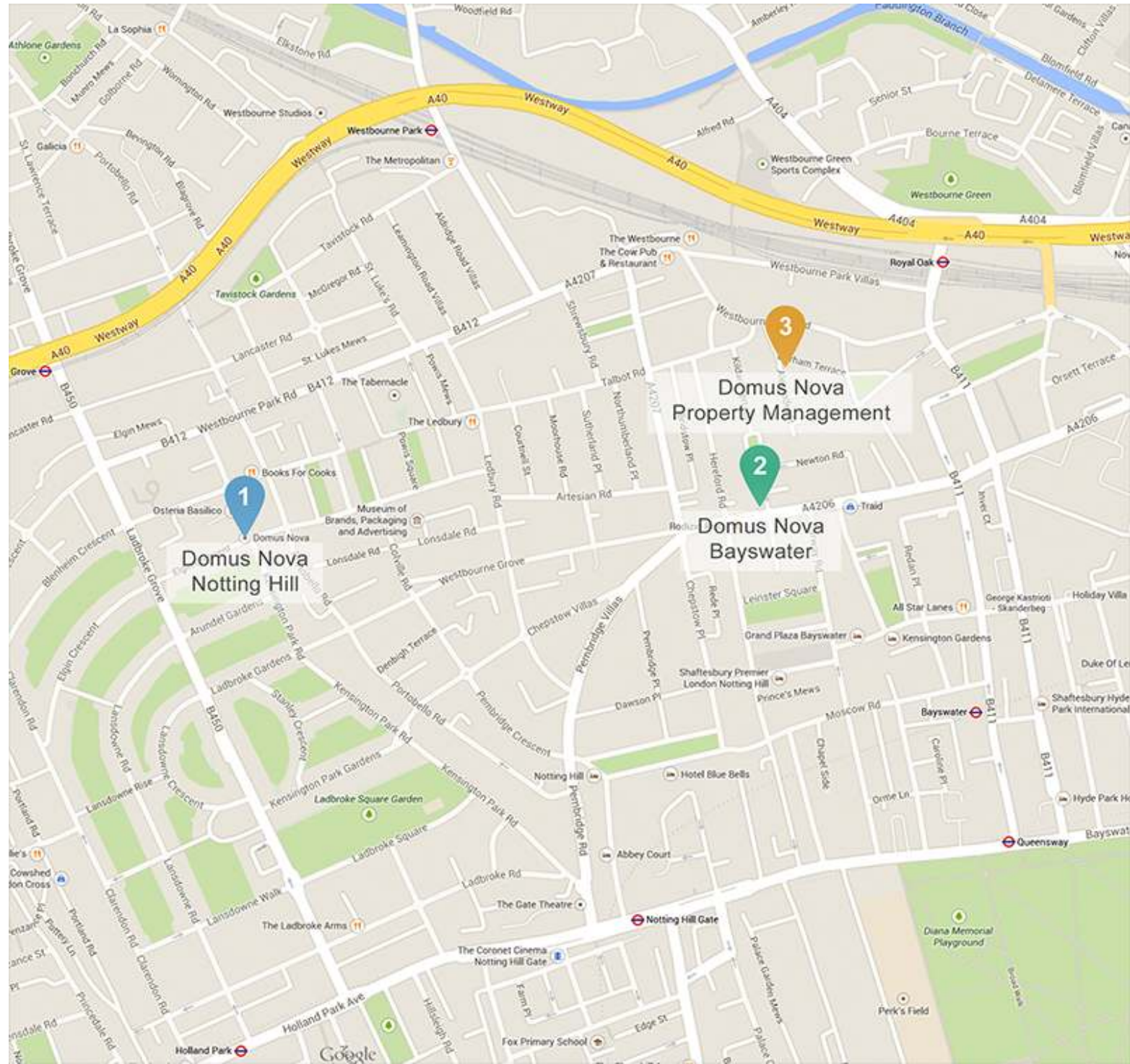



DOMUSNOVA.COM